

WILD

Design Robby Cantarutti & Partners



^{IT} Un nome che evoca la savana e la natura incontaminata: la collezione Wild riprende nella struttura i grafismi disegnati dai rami che nel fitto di una foresta s'intrecciano. La serie di tavoli dining, tavoli bassi, e pouf mantiene una grande coerenza formale e stilistica, donando all'ambiente un tocco esotico. L'alluminio verniciato rende tavoli e pouf resistenti al vento, alla pioggia e allo scolorimento causato dal sole. I cuscini removibili aggiungono un comfort sempre all'insegna della praticità.

La collezione Wild comprende: tavoli dining, tavoli bassi e pouf.

^{EN} A name that brings to mind savannas and untouched nature: the structure of the Wild collection recalls the patterns of intertwined branches in the midst of a thick forest. This collection of dining tables, low tables and poufs maintains great formal and stylistic coherency, bringing an exotic touch to any room. The painted aluminium makes these tables and poufs resistant to wind, rain and colour fading caused by the sun. The removable cushions add comfort at the same time as providing practicality.

The Wild collection includes: dining tables, low tables and poufs.

Descrizione / Description

Misure / Quotes

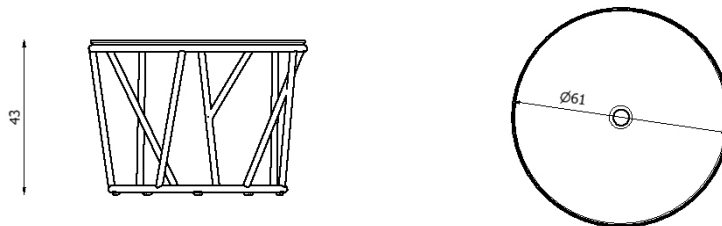
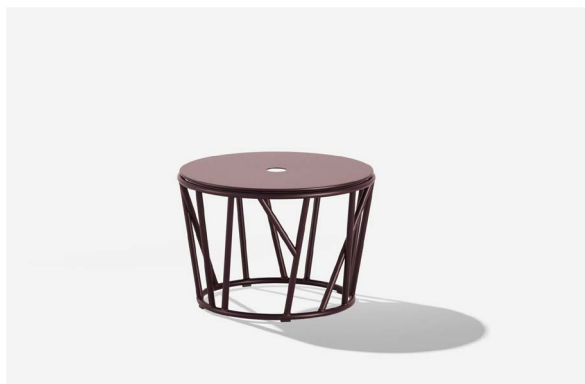

Caratteristiche / Characteristics

Tavolino in alluminio verniciato / Small table in painted aluminium

Design / Design	Robby Cantarutti & Partners 2019	
Dimensioni / Dimensions	Ø 61 x 43 h	
Esterno / Outdoor	Sì / Yes	
Struttura / Structure	Alluminio estruso / Extruded aluminium	
Piedini / Caps	Polipropilene ed elastomero termoplastico / Polypropylene and thermoplastics elastomer	
Finitura / Paint finishes	Verniciatura polveri poliesteri o poliuretaniche / Paint finish with polyester or polyurethane powders	
Impilabilità / Stackability	No	
Viterie assemblaggio / Assembly screws	Acciaio inox / Stainless steel	
Peso netto singolo pezzo / Net weight	3,8 kg	
Pezzi per scatola / Units per package	1 assemblato / 1 assembled	
Dimensione e volume imballo / Packaging dimension and volume	67 x 60 x 62 cm	0.249 m ³
Peso lordo imballo / Packaging Brutto weight	10 kg	
Garanzia / Quality guarantee	2 anni / 2 years	

Descrizione / Description

Misure / Quotes

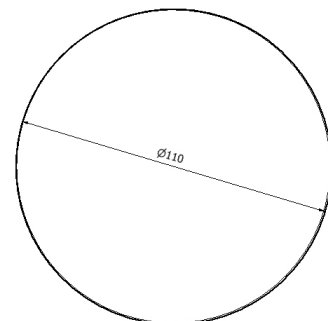
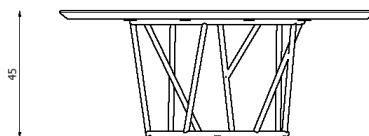

Caratteristiche / Characteristics

Tavolo basso tondo in alluminio verniciato / Round low table in painted aluminium

Design / Design	Robby Cantarutti & Partners 2019
Dimensioni / Dimensions	Ø 110 x 45 h
Esterno / Outdoor	Si / Yes
Struttura / Structure	Alluminio estruso / Extruded aluminium
Piedini / Caps	Polipropilene ed elastomero termoplastico / Polypropylene and thermoplastics elastomer
Finitura / Paint finishes	Verniciatura polveri poliesteri o poliuretaniche / Paint finish with polyester or polyurethane powders
Impilabilità / Stackability	No
Viterie assemblaggio / Assembly screws	Acciaio inox / Stainless steel
Peso netto singolo pezzo / Net weight	15 kg
Pezzi per scatola / Units per package	1 assemblato / 1 assembled
Dimensione e volume imballo / Packaging dimension and volume	131 x 131 x 45 cm 0.772 m ³
Peso lordo imballo / Packaging Brutto weight	31 kg
Garanzia / Quality guarantee	2 anni / 2 years

Descrizione / Description

Misure / Quotes

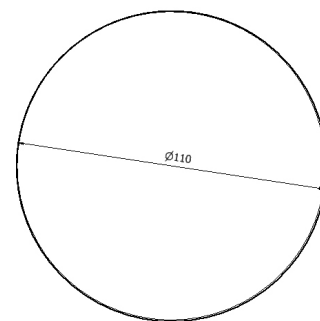
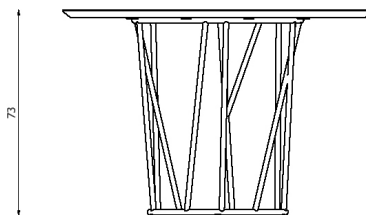

Caratteristiche / Characteristics

Tavolo tondo in alluminio verniciato / Round table in painted aluminium

Design / Design

Robby Cantarutti & Partners | 2019

Dimensioni / Dimensions

Ø 110 x 73 h

Esterno / Outdoor

Sì / Yes

Struttura / Structure

Alluminio estruso / Extruded aluminium

Piedini / Caps

Polipropilene ed elastomero termoplastico / Polypropylene and thermoplastics elastomer

Finitura / Paint finishes

Verniciatura polveri poliestere o poliuretaniche / Paint finish with polyester or polyurethane powders

Impilabilità / Stackability

No

Viterie assemblaggio / Assembly screws

Acciaio inox / Stainless steel

Peso netto singolo pezzo / Net weight

16 kg

Pezzi per scatola / Units per package

1 assemblato / 1 assembled

Dimensione e volume imballo / Packaging dimension and volume

131 x 131 x 77 cm 1,321 m³

Peso lordo imballo / Packaging Brutto weight

33 kg

Garanzia / Quality guarantee

2 anni / 2 years

Descrizione / Description

Misure / Quotes

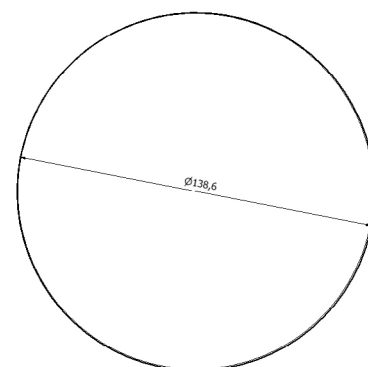
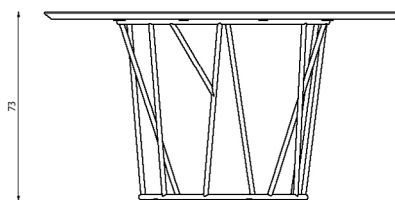

Caratteristiche / Characteristics

Tavolo tondo in alluminio verniciato / Round table in painted aluminium

Design / Design

Robby Cantarutti & Partners | 2019

Dimensioni / Dimensions

Ø 138,6 x 73 h

Esterno / Outdoor

Sì / Yes

Struttura / Structure

Alluminio estruso / Extruded aluminium

Piedini / Caps

Polipropilene ed elastomero termoplastico / Polypropylene and thermoplastics elastomer

Finitura / Paint finishes

Verniciatura polveri poliestere o poliuretaniche / Paint finish with polyester or polyurethane powders

Impilabilità / Stackability

No

Viterie assemblaggio / Assembly screws

Acciaio inox / Stainless steel

Peso netto singolo pezzo / Net weight

22,5 kg

Pezzi per scatola / Units per package

1 assemblato / 1 assembled

Dimensione e volume imballo / Packaging dimension and volume

148 x 148 x 82 cm 1,796 m³

Peso lordo imballo / Packaging Brutto weight

40 kg

Garanzia / Quality guarantee

2 anni / 2 years

Descrizione / Description

Misure / Quotes



48

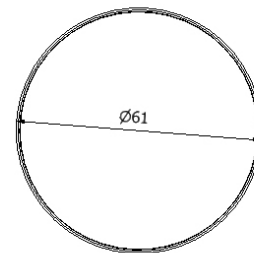
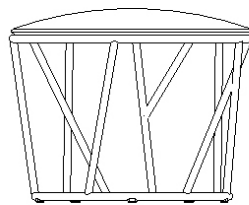

Caratteristiche / Characteristics

Pouf in alluminio verniciato con cuscino removibile / Pouf in painted aluminium with removable cushion

Design / Design

Robby Cantarutti & Partners | 2019

Dimensioni / Dimensions

Ø 61 x 48 h

Esterno / Outdoor

Si / Yes

Struttura / Structure

Alluminio estruso / Extruded aluminium

Piedini / Caps

Polipropilene ed elastomero termoplastico / Polypropylene and thermoplastics elastomer

Finitura / Paint finishes

Verniciatura polveri poliestere o poliuretaniche / Paint finish with polyester or polyurethane powders

Impilabilità / Stackability

No

Viterie assemblaggio / Assembly screws

Acciaio inox / Stainless steel

Peso netto singolo pezzo / Net weight

6 kg

Pezzi per scatola / Units per package

1 assemblato / 1 assembled

Dimensione e volume imballo / Packaging dimension and volume

67 x 60 x 62 cm 0,249 m³

Peso lordo imballo / Packaging Brutto weight

12 kg

Garanzia / Quality guarantee

2 anni / 2 years

Descrizione / Description

Misure / Quotes

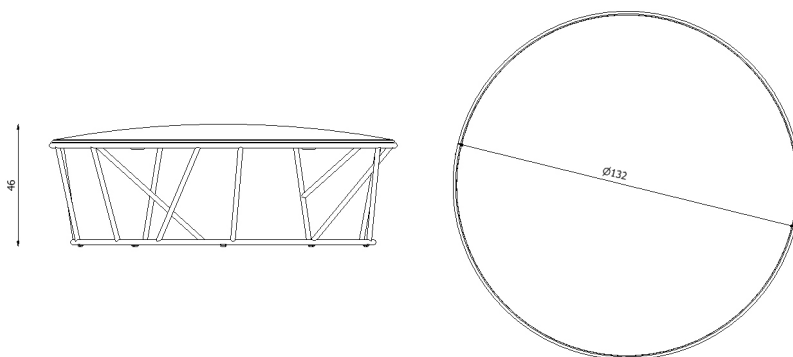

Caratteristiche / Characteristics

Pouf in alluminio verniciato con cuscino removibile / Pouf in painted aluminium with removable cushion

Design / Design	Robby Cantarutti & Partners 2019
Dimensioni / Dimensions	Ø 132 x 46 h
Esterno / Outdoor	Si / Yes
Struttura / Structure	Alluminio estruso / Extruded aluminium
Piedini / Caps	Polipropilene ed elastomero termoplastico / Polypropylene and thermoplastics elastomer
Finitura / Paint finishes	Verniciatura polveri poliestere o poliuretaniche / Paint finish with polyester or polyurethane powders
Impilabilità / Stackability	No
Viterie assemblaggio / Assembly screws	Acciaio inox / Stainless steel
Peso netto singolo pezzo / Net weight	26 kg
Pezzi per scatola / Units per package	1 assemblato / 1 assembled
Dimensione e volume imballo / Packaging dimension and volume	148 x 148 x 55 cm 1,204 m ³
Peso lordo imballo / Packaging Brutto weight	39 kg
Garanzia / Quality guarantee	2 anni / 2 years

Manutenzione / Maintenance

Alluminio verniciato: Le operazioni di ordinaria pulizia per l'alluminio verniciato vanno eseguite con acqua tiepida e detergente neutro, utilizzando un panno morbido, evitando l'utilizzo di prodotti abrasivi, aggressivi, a base acida o alcalina.

Painted aluminium: Perform routine cleaning on painted aluminium with warm water and neutral detergent, using a soft cloth. Do not use aggressive, abrasive, acid- or alkalibased products.